

Sep.1.2024 Copyright 2024 HIROSE ELECTRIC CO., LTD. All Rights Reserved.  
In case of consideration for using Automotive equipment / device which demand high reliability, kindly contact our sales window correspondents.

1			2			3			4		
COUNT	DESCRIPTION OF REVISIONS	BY	CHKD	DATE	COUNT	DESCRIPTION OF REVISIONS	BY	CHKD	DATE	COUNT	DESCRIPTION OF REVISIONS
△					△					△	
△					△					△	
△					△					△	

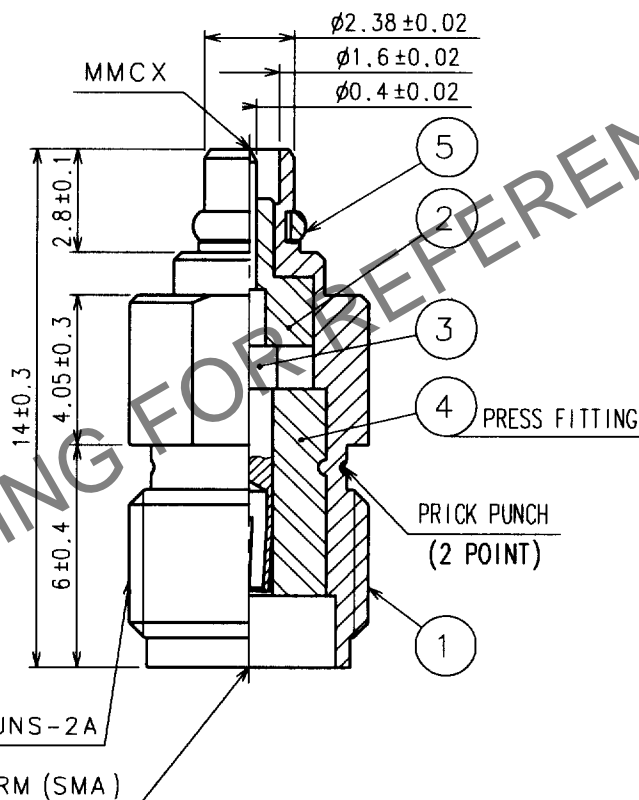
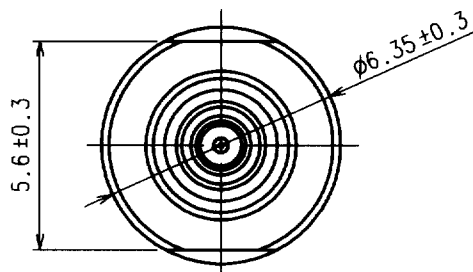

3	BERYLLIUM COPPER	GOLD PLATING	5	BERYLLIUM COPPER	GOLD PLATING
2	PTFE		4	PTFE	
1	STAINLESS STEEL	GOLD PLATING			
NO.	MATERIAL	FINISH, REMARKS	NO.	MATERIAL	FINISH, REMARKS
CODE NO. (OLD)			DRAWN N. Ninomiya 01.5.9		
			DESIGNED N. Ninomiya 01.5.9		
			CHECKED J. Mitani 01.5.9		
			APPROVED K. Kobayashi 01.05.09		
			RELEASED		
DRAWING NO. EDC4-134344			PART NO. HRMJ-MMCXP		
CODE NO. CL311-0313-4			1/1		
HRS HIROSE ELECTRIC CO., LTD.					

TO
RF